

Combination Meter Components

BENE31J19306001

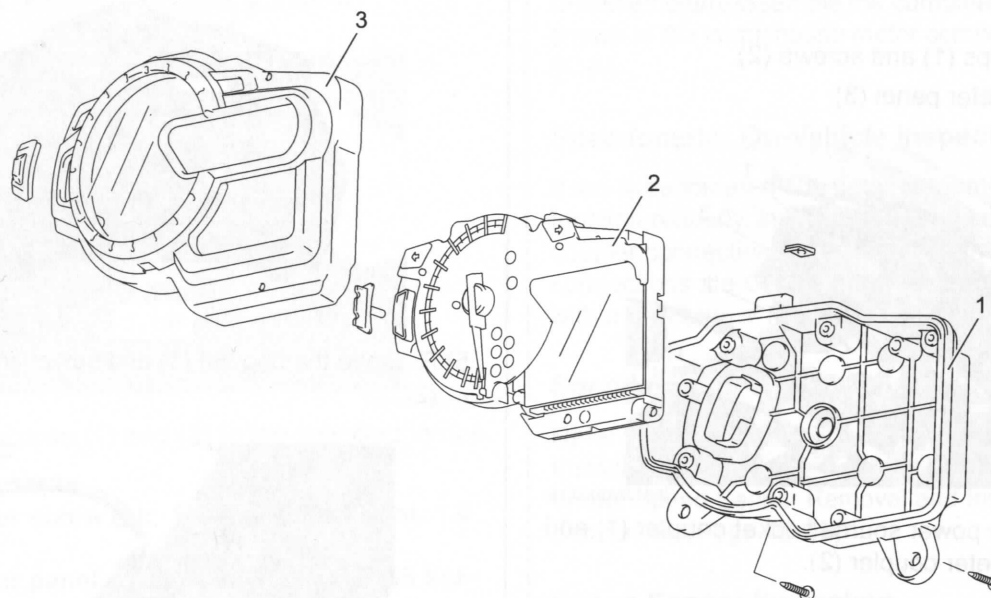

IE31J1930032-02

1. Lower case	2. Speedometer	3. Upper case
---------------	----------------	---------------

Combination Meter On-Vehicle Inspection

BENE31J19306002

LED Inspection

Check that the LEDs (FI indicator light (1), ABS indicator light (2), Engine coolant temperature indicator light / Oil pressure indicator light (3), Freeze indicator light (4) and TC indicator light (5) and Neutral indicator (6)) immediately light up when the ignition switch is turned to ON.

Check that other LEDs (High-beam indicator light (7) and Turn signal indicator lights (8)) light up/go off by operating the brake lock lever, the dimmer and the turn signal switches.

If abnormal condition is found, replace the combination meter unit with a new one after checking its wire harness/coupler. (Page 9C-5)

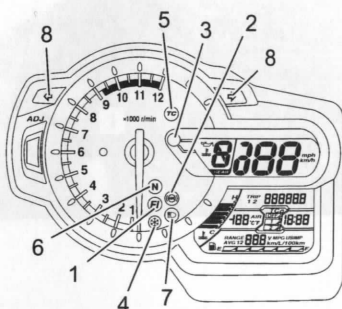

IE31J1930027-02

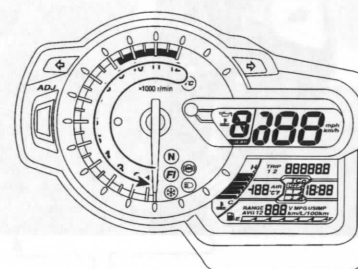

IE31J1930028-02

NOTE

The pointer may not return to the proper position even turning the ignition switch on under low temperature condition. In that case, you can reset the pointer to the proper position by the following instruction.

- 2) With the adjust switch (1) pressed, turn the ignition switch ON.
- 3) Hold the adjust switch pressed for more than 4 seconds, the needle shakes fully and returns "0".
- 4) Release the adjust switch.
- 5) If the pointer does not return to "0", replace the combination meter with a new one. (Page 9C-5)

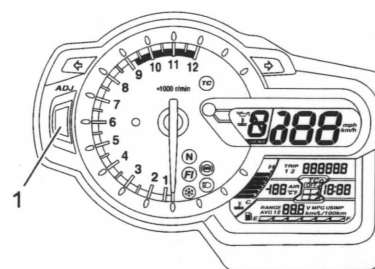

IE31J1930029-01

Stepping Motor Inspection and Adjustment

- 1) Check that the pointer calibrates itself immediately after turning the ignition switch on and stops at zero point.

If abnormal condition is found, replace the combination meter unit with a new one after checking its wire harness/coupler.